

Board of Adjustment **Notification Plan for** **Case No A-21-10300141**



San Antonio City Limits



Subject Property



200' Notification Boundary



Council District: 1



1 inch equals 100 feet

"NOT TO SCALE,
FOR ILLUSTRATIVE PURPOSES ONLY"

Development Services Department
City of San Antonio

Site Plan

PLOT PLAN FOR BUILDING PERMITS

Address: 1419 W. Grimmercy Pl

Lot: 20

Block: 59

NCB: 2753

REAR

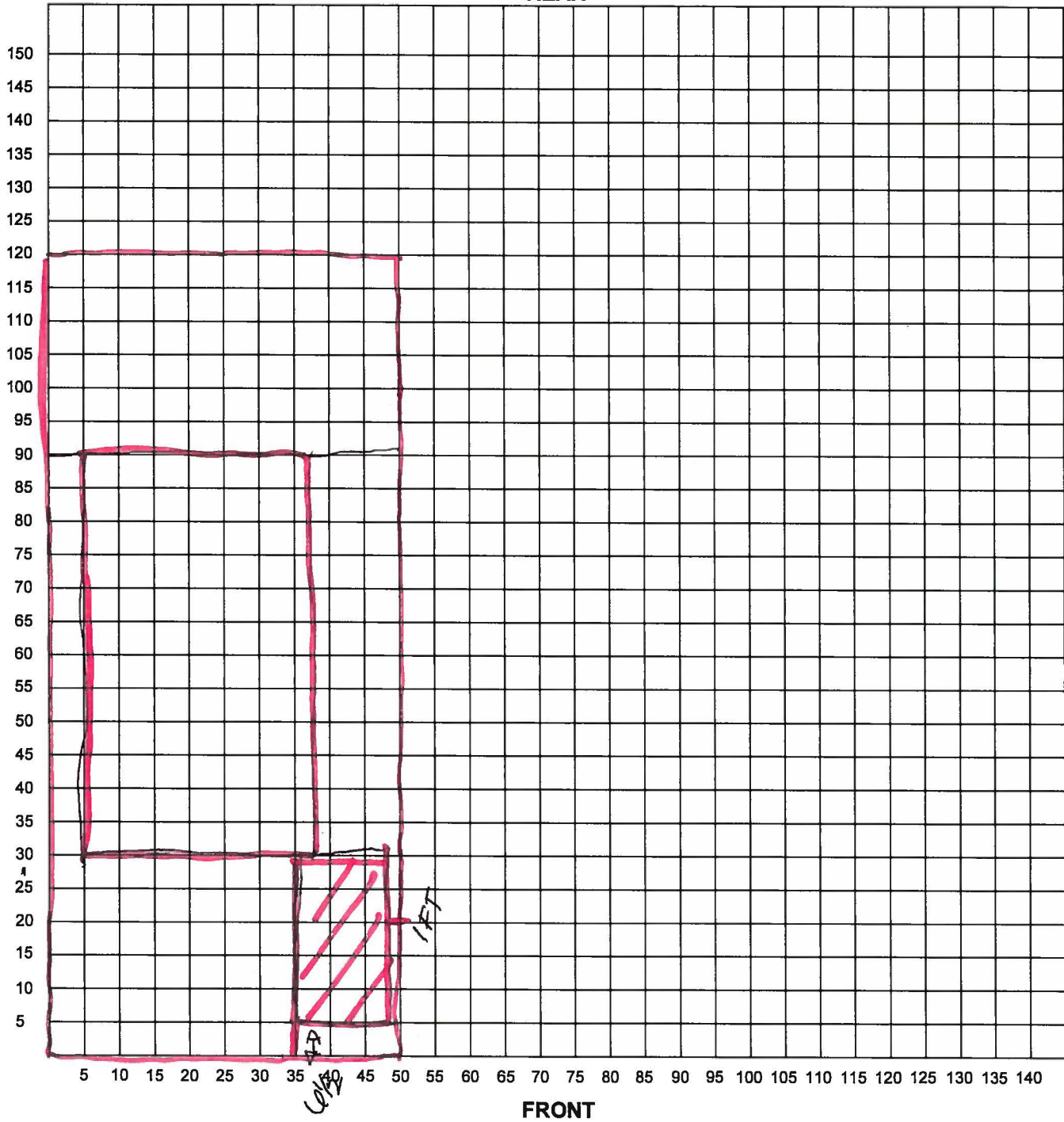

I certify that the above plot plan shows all improvements on this property and that there will be no construction over easements. I also certify that I will build in compliance with the UDC and the 2015 IRC.

BOA-21-10300141

Subject Property: 1419 West Gramercy Place



Front of Carport 9" away from side property line



Rear portion of carport 1" from side property line



Front Yard Fence along eastern property line



Front Yard Fence 6' tall along western property line



6' Tall Portion of Front Yard Fence exceeding façade of home by 18'



Surrounding Area



Surrounding Area



Surrounding Area

