

Development Services Department
City of San Antonio

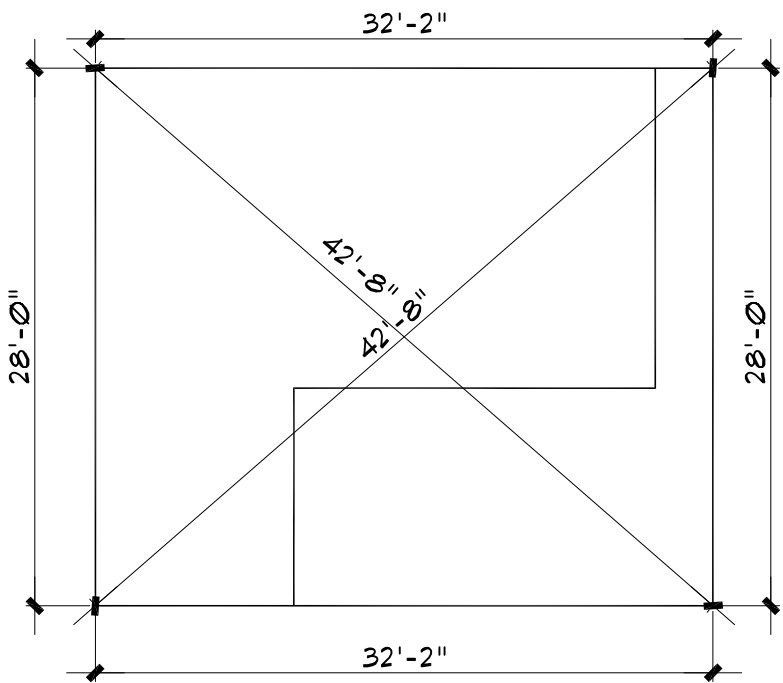

GROUND COVERAGE	
TOTAL LOT AREA	4095 SQFT
TOTAL GROUND AREA	5518 SQFT
LANDSCAPE AREA	3096 SQFT
SLAB AREA	1801 SQFT
A/C PAD AREA	32 SQFT
CONC. STOOP AREA	32 SQFT
DRIVEWAY AREA	190 SQFT
APRON AREA	230 SQFT
ENTRY WALK AREA	131 SQFT
NEW WOOD FENCE	171 LF
IMPERVIOUS COVER	2055 SQFT

DIAGONAL PLAN

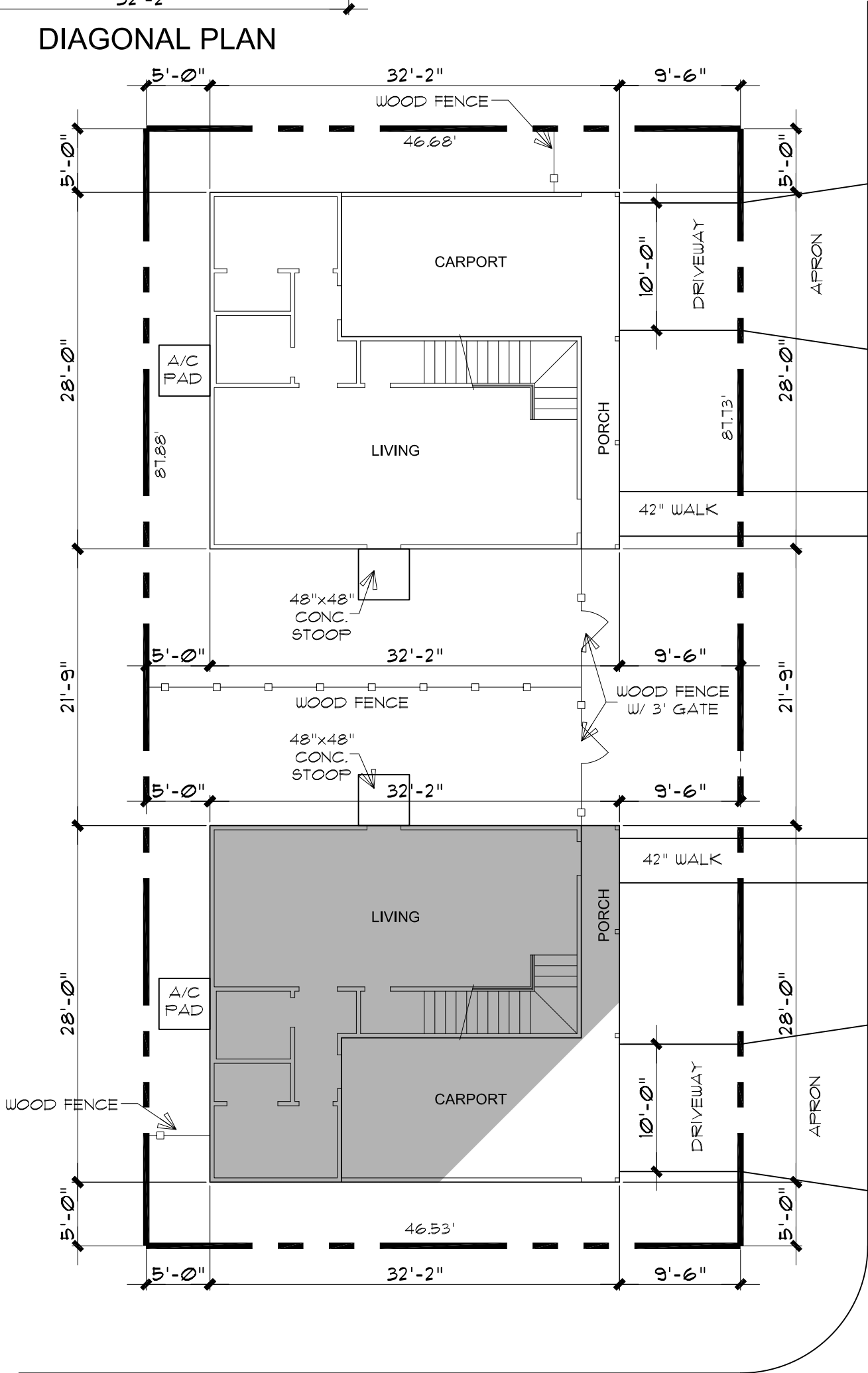

301 PIEDMONT AVE.

PLOT PLAN

SCALE: 1"=10'-0"

THE EAST 87.99' OF LOT 10, BLOCK 1, N.C.B. 1691
BEXAR COUNTY, TEXAS



BOA-22-10300123

Subject Property: 301 Piedmont



Residences will front on Wyoming (Shown)



Rear of property



View of Piedmont Avenue



Surrounding area



Surrounding area

