

Zoning Case: Z-2024-10700025 CD

I, Daniel Sowell, the property owner, acknowledge that this site plan submitted for the purpose of rezoning this property is in accordance with the applicable provisions of the Unified Development Code. Additionally, I understand that the City Council approval of a site plan in conjunction with the rezoning case does not relieve me from adherence to any/all City adopted codes at the time of the plan submittal for building permits.

Zoning:

From: "R-6 MLOD-2 MLR-2 AHOD"
Residential Single-Family Lackland Military
Lighting Overlay Military Lighting Region 2
Airport Hazard Overlay District
To: "R-6 CD MLOD-2 MLR-2 AHOD"
Residential Single-Family Lackland Military
Lighting Overlay Military Lighting Region 2
Airport Hazard Overlay District with a Conditional
Use for Three (3) Dwelling Units

Main House: 2,756 sqft

Duplex: 3,908 sqft

Impervious Coverage: 3,135 sqft

Property: 22,503.10 sqft

Landscaping: Various trees throughout property

■ Concrete/Impervious Cover

○ Trees

— 6' - White Rock Wall

- - - 6' - Wood Fence

- - - - 4' - Iron Gate

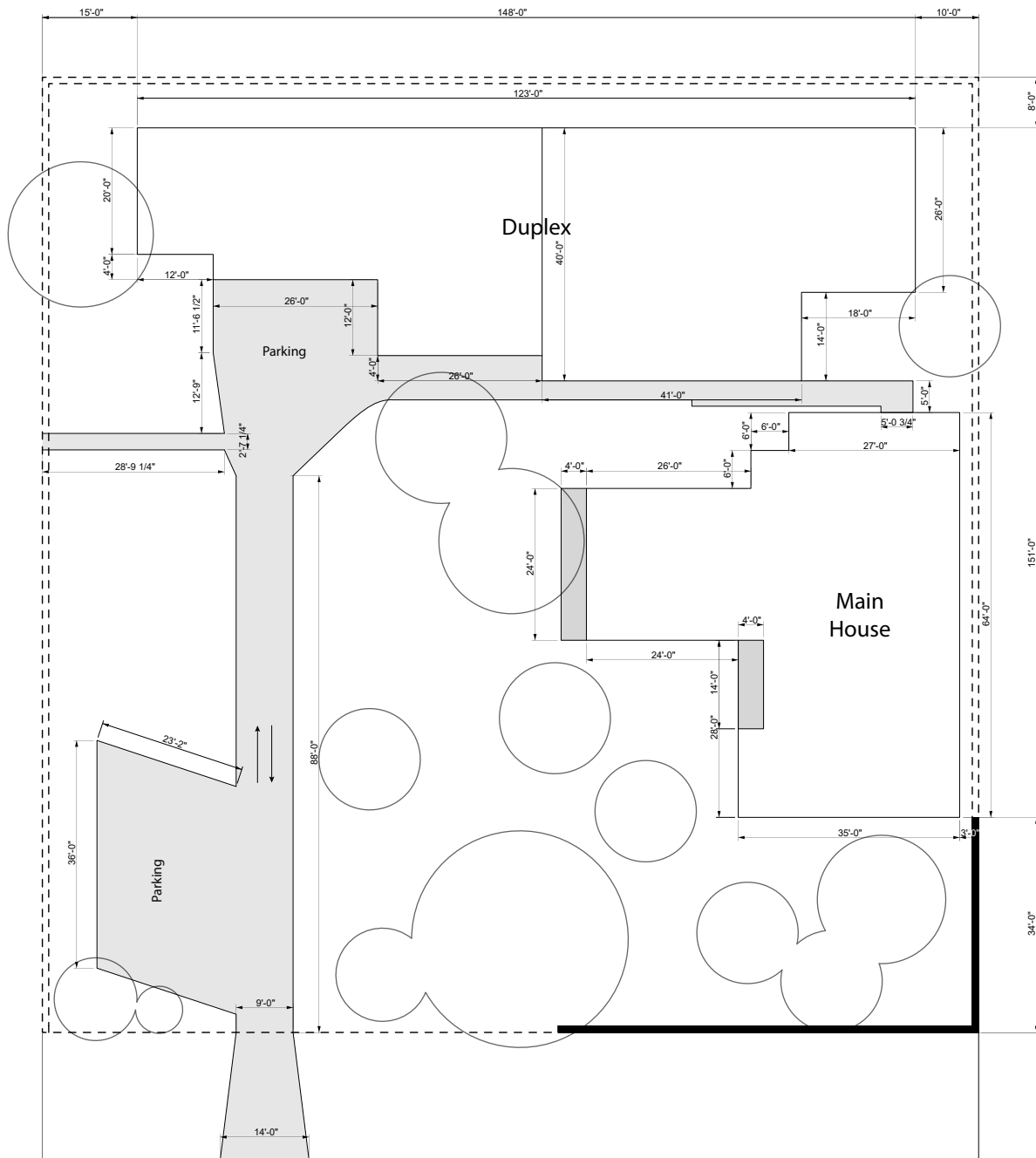

East Hart Avenue

Scale: 1/8" = 1'