



# **Board of Adjustment** **Notification Plan for** **Case No A-21-10300171**



- San Antonio City Limits
- Subject Property
- 200' Notification Boundary
- Council District: 1



"NOT TO SCALE,  
 FOR ILLUSTRATIVE PURPOSES ONLY"

Development Services Department  
 City of San Antonio



# Site Plan

## SITE PLAN & FIRST FLOOR PLAN

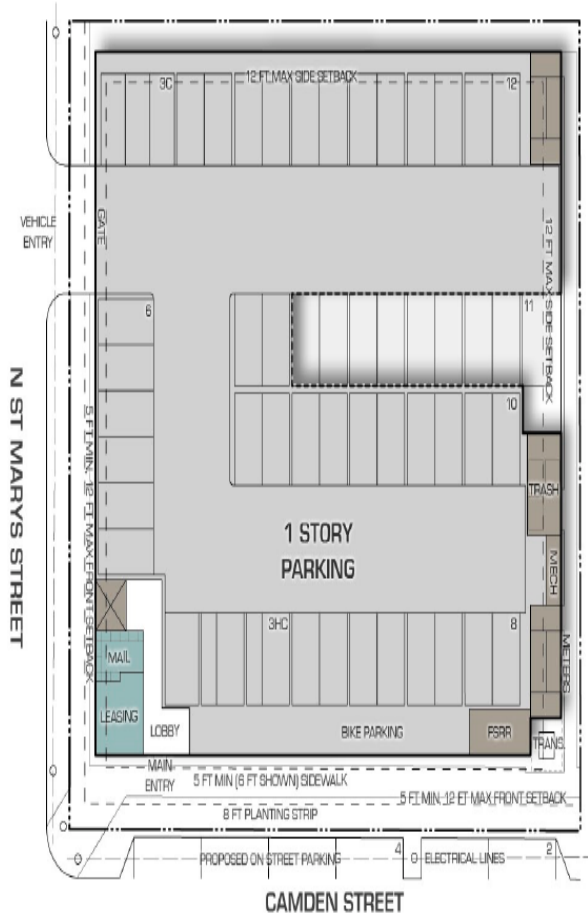

## UPPER FLOORS



## TABULATIONS

SITE AREA: 0.60 AC.

### UNIT TABULATION:

STUDIOS: 24 UNITS (40.68%)  
 1 BEDROOM: 35 UNITS (59.32%)  
**TOTAL: 59 UNITS**  
 @ 98.33 UNITS/ACRE

### PARKING TABULATION:

STRUCTURED: 53 SPACES  
 ON STREET: 06 SPACES  
**TOTAL: 59 SPACES**  
 @ 1.00 PARKING/UNIT  
 @ 1.00 PARKING/BED

AVG. UNIT SIZE: 670 SQ. FT.

\*44 OFF STREET SPACES REQUIRED  
 (0.75P/UNIT)



## ST MARYS HIGHLINE: SCHEMATIC SITE PLAN

San Antonio, Texas

#21228/ 11.01.2021  
 URBAN GENESIS



**BOA-21-10300171**

**Subject Property: 1610 North Saint Mary's Street**



**Subject Property**





## Subject Property



## Surrounding Area





Surrounding Area



Surrounding Area

