





Data Source: City of San Antonio Enterprise GIS, Bexar Metro 911, Bexar Appraisal District

*This Geographic Information System Product, received from The City of San Antonio is provided "as is" without warranty of any kind, and the City of San Antonio expressly disclaims all express and implied warranties, including but not limited to the implied warranties of merchantability and fitness for a particular purpose. The City of San Antonio does not warrant, guarantee, or make any representation regarding its use, or the results of the use, of the information provided to you by the City of San Antonio in terms of completeness, accuracy, reliability, timeliness or otherwise. The user assumes all responsibility for the use and performance of any information obtained from the City of San Antonio is entirely assumed by the recipient.

**These contents are the property of the City of San Antonio. Reproduction for specific information.

City of San Antonio Planning Department GIS Manager: "Vivian Woods" E-mail: vwoods@sanantonio.gov. Maps may be ordered at: (210) 207-7873

Map Created by: Gustavo Gutierrez
 Map Creation Date: 7/27/2023
 Map File Location: \\sacommon\\misc\\28\\GIS\\Plan_3b\\Archived\\Neighborhoods\\Land_Use\\Amendment\\Amend_2311600054_NearNW\\C_B&W.mxd
 PDF Filename: 2307GO.pdf

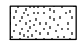
-  200' Notification Area
-  Community Commercial
-  Proposed Land Use Change
-  Urban Low Density Residential
-  Low Density Residential
-  Public Institutional

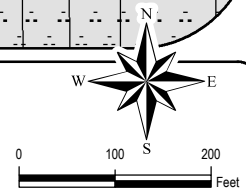

Near Northwest Community Plan

Proposed Plan Amendment 2311600054 Area

City of San Antonio
 Development Services
 Department

Michael Shannon, PE, CBO

City of San Antonio
 100 N. Nueces Street
 PO Box 939990
 San Antonio, TX 78293

