

214 E Lachapelle  
San Antonio TX 78204

Zoning from: R6  
Zoning to: IDZ2 – 3 story single family residence w/ 2 car garage

Z-2023-10700005

Current Zoning: "R-6 AHOD" Residential Single-Family Airport Hazard Overlay District

Requested Zoning: "IDZ-2 AHOD" Medium Intensity Infill Development Zone Airport Hazard Overlay District with uses permitted for one (1) dwelling unit

Legal Description: 0.065 acres out of NCB 2582

Density proposed: 1 single-family dwelling proposed

Landscaping: No major landscaping proposed; no landscape buffer required

Parking: 2 spaces provided, 9' x 18'

Square footage of structure: +/- 3800 sq/ft

Height: 3 stories / 35'

Setbacks- 5' side and rear perimeter; no front setback

0.0237 ACRES of open space

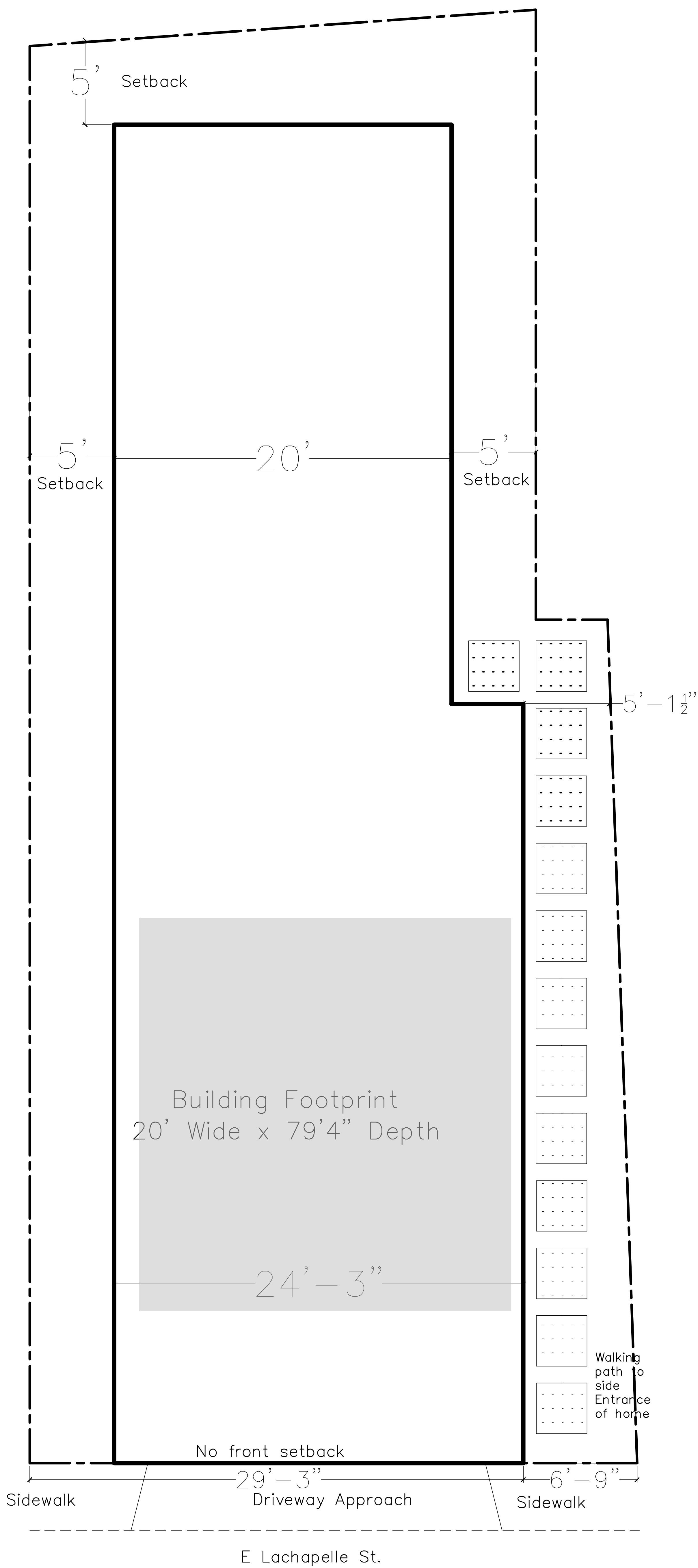

Approximate location of garage parking

Concrete Total square footage of concrete area- 117 sq/ft

Fence Steel or cement based fence proposed- 8' rear, 6' on the side

N

“I, Jagath Santha, owner of JS7 Investments, the property owner, acknowledge that this site plan submitted for the purpose of rezoning this property is in accordance with all applicable provisions of the Unified Development Code. Additionally, I understand that City Council approval of a site plan in conjunction with a rezoning case does not relieve me from adherence to any/all City adopted Code at the time of plan submittal for building permits.”