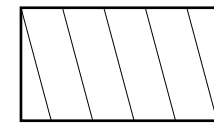

 **LOCATION MAP**
SCALE: 1" = 100'-0"

LEGEND

-  AREA OF PROPOSED DEVELOPMENT
-  PROPERTY LINE
-  PROPOSED SETBACK

Gross Density: 20 units/acre

- TOTAL AREA OF PROPOSED DEVELOPMENT: 18.24 ACRES
- 360 APARTMENT UNITS TOTAL
- MAX BUILDING HEIGHT: 3 STORIES

CURRENT ZONING: "C-2 H RIO-5 MC-1 AHOD"
"C-1 H RIO-5 MC-1 AHOD"
"C-2 H MC-1 AHOD"
"C-1 H MC-1 AHOD"
"C-1 S H MC-1 AHOD"
"I-1 H AHOD"
"C-2 NA H AHOD"

REQUESTED ZONING: "MXD" (ALL OVERLAYS REMAIN)

I, CJS RS, LLC, the property owner, acknowledge that this site plan submitted for the purpose of rezoning this property is in accordance with all applicable provisions of the Unified Development Code. Additionally, I understand that City Council approval of a site plan in conjunction with a rezoning case does not relieve me from adherence to any/all City adopted Codes at the time of plan submittal for building permits."

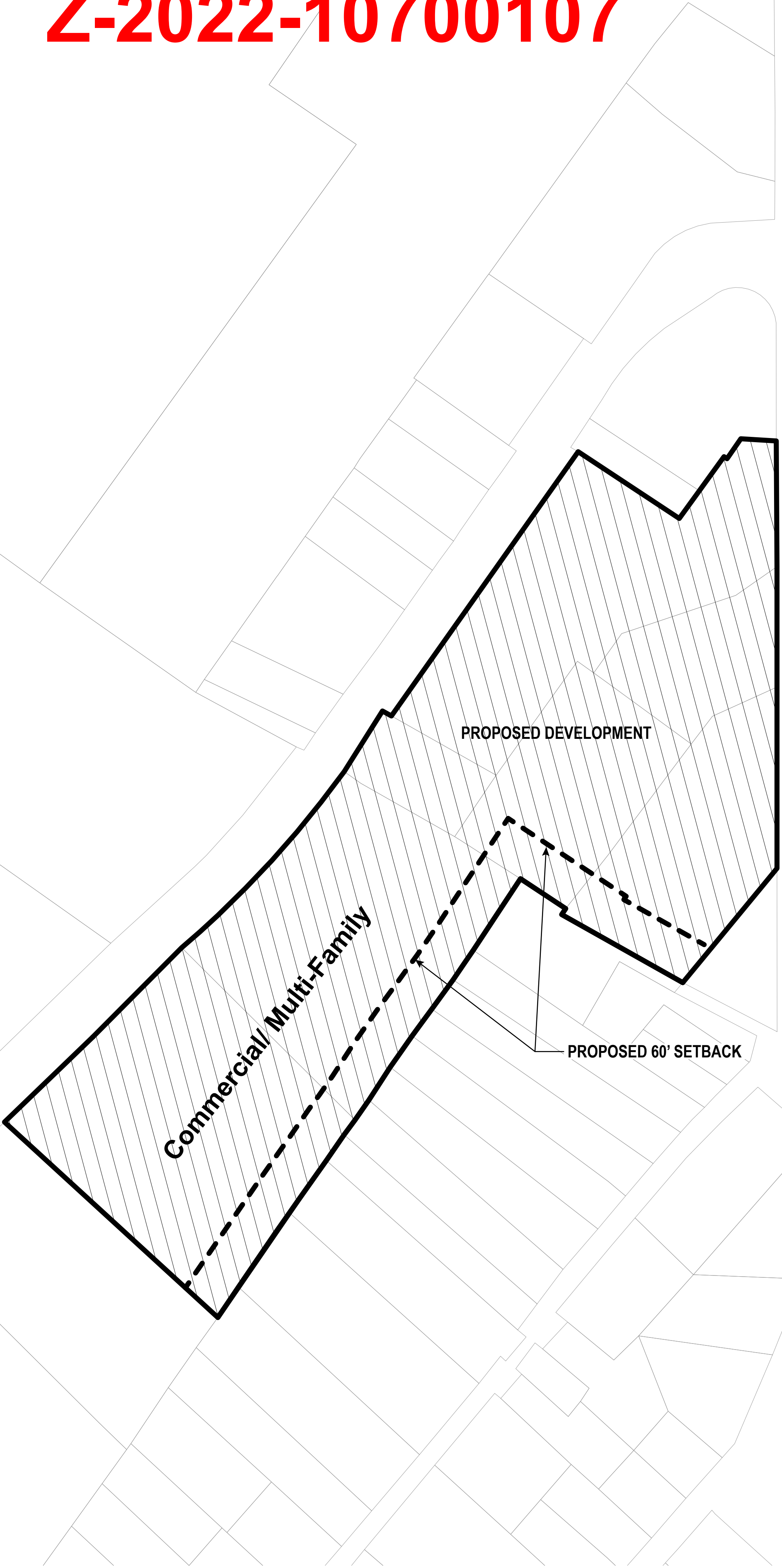

ROOSEVELT AVE

ROOSEVELT AVE

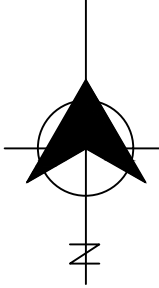

SITE PLAN
SCALE: 1" = 100'-0"