

Z-2024-10700023 CD

7150 New Laredo Highway

Lot 68 and Lot 151, Block 1, NCB 11253

**Zoning Request:**

From: "C-2 MLOD-2 MLR-1 AHOD" Commercial  
Lackland Military Lighting Overlay Military Lighting  
Region 1 Airport Hazard Overlay District

To: "C-2 CD MLOD-2 MLR-1 AHOD" Commercial  
Lackland Military Lighting Overlay Military Lighting  
Region 1 Airport Hazard Overlay District with a  
Conditional Use for Motor Vehicle Sales

I, Norma Vela, the property owner, acknowledge that this site plan submitted for the purpose of rezoning this property is in accordance with all applicable provisions of the Unified Development Code. Additionally, I understand that City Council approval of a site plan in conjunction with a rezoning case does not relieve me from adherence to any/all City-adopted Codes at the time of plan submittal for building permits."

Parking: 27 Spaces at 9' x 18'

Impervious Coverage: 21,306 sq. ft.

Existing Building 1: 1,102 sq. ft.

Existing Building 2/New Addition: 912 sq. ft.

Existing Storage: 960 sq. ft.

6' Wrought Iron Perimeter Fence

**NEW LAREDO HWY  
86' ROW**

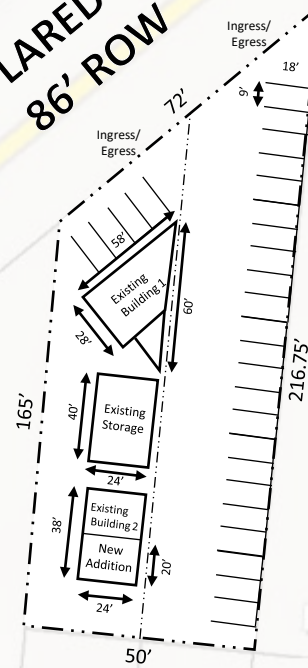

1:1,000

