

Data Source: City of San Antonio Enterprise GIS, Bexar Metro 911, Bexar Appraisal District  
 "This Geographic Information System Product, received from The City of San Antonio is provided "as is" without warranty of any kind, and the City of San Antonio expressly disclaims all express and implied warranties, including but not limited to the implied warranties of merchantability and fitness for a particular purpose. The City of San Antonio does not warrant, guarantee, or make any representations regarding the use, or the results of the use, of the information provided to you by the City of San Antonio in terms of correctness, accuracy, reliability, timeliness or otherwise. The entire risk as to the results and performance of any information obtained from the City of San Antonio is entirely assumed by the recipient."  
 \*Please contact the responsible City of San Antonio Department for specific determinations.  
 Map Created by: Gustavo Gutierrez  
 Map Creation Date: 8/12/2024  
 Map File Location: \\scomminisc29\GIS\Plan50\plan\_1\B\Archived\Neighborhoods  
 Land\_Use\Amendments\Amend\_2411600058\_Arena\_B&W.mxd  
 PDF Filename: 240800

- 200' Notification Area
- Proposed Land Use Change
- Medium Density Residential
- Urban Low Density Residential
- Neighborhood Mixed Use
- Urban Mixed Use

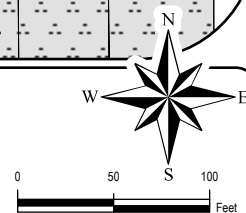

# Eastside Community Area Plan

## Proposed Plan Amendment 2411600058 Area

City of San Antonio  
 Development Services  
 Department  
 Michael Shannon, PE, CBO  
 CRR Morton Development and  
 Business Services Center  
 PO Box 85996  
 San Antonio, TX 78283