

Data Source: City of San Antonio Enterprise GIS, Bexar Metro 911, Bexar Appraisal District
 "This Geographic Information System Product, received from The City of San Antonio is provided "as is" without warranty of any kind, and the City of San Antonio expressly disclaims all express and implied warranties, including but not limited to the implied warranties of merchantability and fitness for a particular purpose. The City of San Antonio does not warrant, guarantee, or make any representation regarding the use, or the results of the use, of the information provided to you by the City of San Antonio in terms of correctness, accuracy, reliability, timeliness or otherwise. The entire risk as to the results and performance of any information obtained from the City of San Antonio is entirely assumed by the recipient."
 Map Created by: Gustavo Gutierrez
 Map Creation Date: 11/21/2024
 Map File Location: \\sacommnet\misc\29\GIS\Pin50\plan_jlb\Archived\Neighborhoods
 Land_Use\Amendments\Amend_2411600087_Medical_Center_B&W.mxd
 PDF Filename: 2411GG



200' Notification Area



Proposed Land Use Change



Medium Density Residential



Regional Mixed Use



Urban Mixed-Use

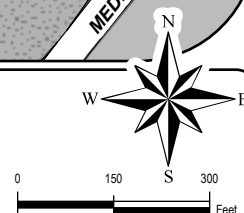

Medical Center Area Regional Center **Proposed Plan Amendment 2411600087 Area**

City of San Antonio
 Development Services
 Department

Michael Shannon, PE, CBO

CRF Morton Development and
 Business Services Center
 PO Box 419950
 San Antonio, TX 78283

