

Zoning Case Notification Plan Case Z-2024-10700159

Council District: 3
School District: East Central I.S.D.
Scale: 1" = 250 Feet

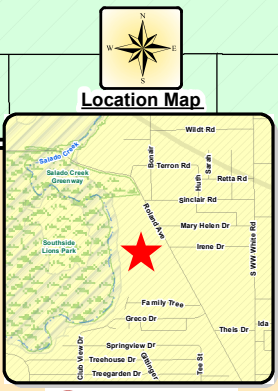

Legend	
Subject Property(ies)	
200 Ft. Notification Area	
Single Family Residential	R-5
Current Land Use Description	TEXT
Current Zoning	TEXT
Requested Zoning Change	(TEXT)
Creek / River Region	
City Limits	
Corridor Overlay	
ERZD Region	
MLOD Region	
AHOD Region	



Note: All Current and Requested Zoning include: MLOD-3 / MLR-2 Overlay District

