

93'x84' = 7,812 sq. feet lot  
 Each Lot - 46.5' x 84' = 3,906 sq. feet.  
 Total Open Space = 4,892 sq. feet

# Residential Uses

- 6 parking spaces
- 3 per home

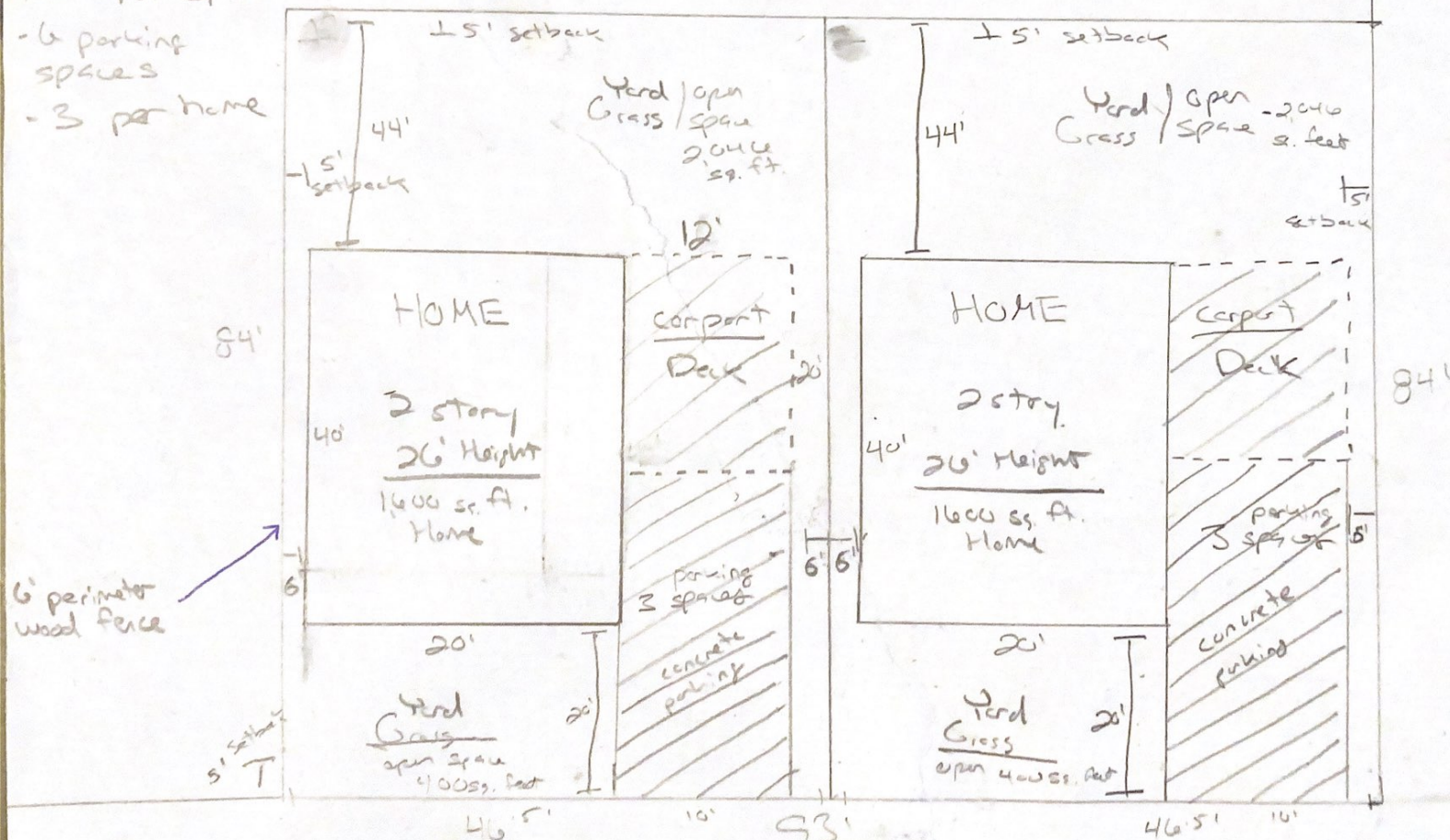

There is no industrial or commercial acreage.

Total Impervious Coverage= 2,800 sq/ft  
 (Approximately 36% of total lot size) Total  
 Lot size= 7,812 sq/ft

From: "R-4" Residential Single-Family District  
 To: "IDZ-1 Limited Intensity Infill Development  
 Zone District with uses permitted for two (2)  
 dwelling units

"I, John Bonillas, the property owner, acknowledge that this site plan submitted for the purpose of rezoning this property is in accordance with all applicable provisions of the Unified Development Code. Additionally, I understand that City Council approval of a site plan in conjunction with a rezoning case does not relieve me from adherence to any/all City-adopted Codes at the time of plan submittal for building permits."

201 Woodby Ct.