

# Ground Plan Comparison Form

## IDZ-1 and IDZ-2/3 less than or equal to 1 acre

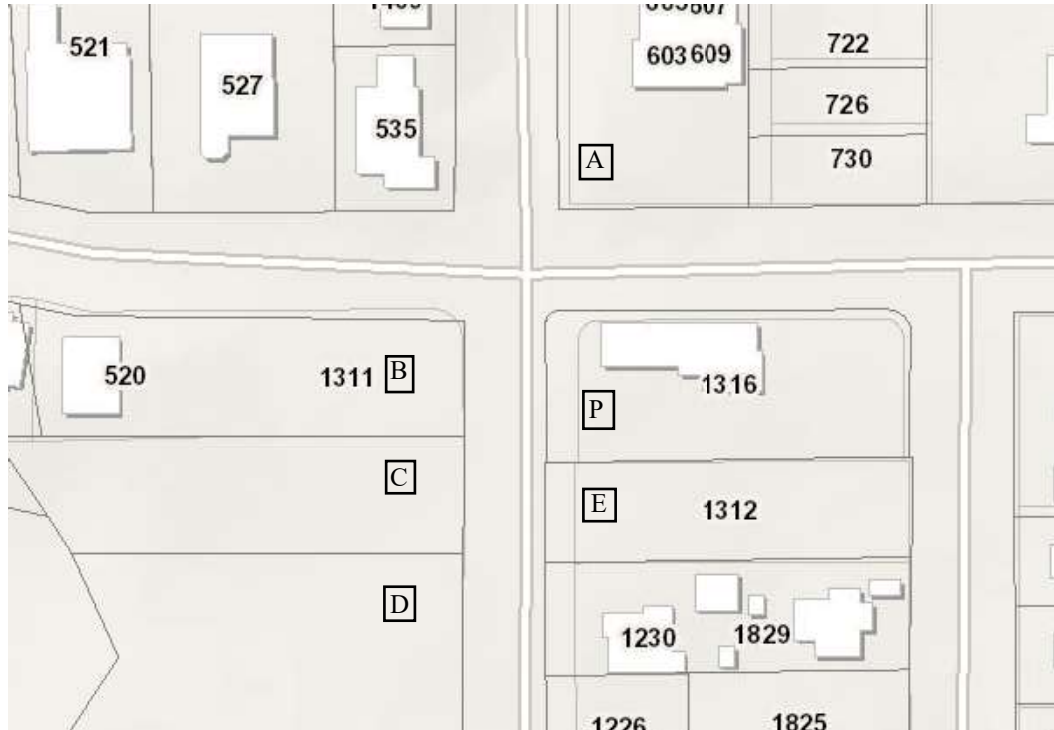

Address	1. Setback to Structure	2. Setback to Porch( If Applicable)	3. Setback to Left Property Line	4. Setback to Right Property Line	5. Building Height
P. 1316 Austin St.	5'-0"	N/A	5'-0"	5'-0"	16 stories
A. 603 E Grayson St.	+/- 58'	N/A	+/-30'	+/-8'	2 stories
B. 520 E Grayson St.	+/- 13'	N/A	+/-15'	+/-171'	1 story
C. 1215 Austin St.	N/A	N/A	N/A	N/A	N/A
D. 1203 Austin St.	+/-5'	N/A	+/-5'	+/-5'	5 stories
E. 1312 Austin St.	N/A	N/A	N/A	N/A	N/A