

I, OSCAR CARILLO, THE PROPERTY OWNER REPRESENTATIVE, ACKNOWLEDGE THAT THIS SITE PLAN SUBMITTED FOR THE PURPOSE OF REZONING THIS PROPERTY IS IN ACCORDANCE WITH ALL APPLICABLE PROVISIONS OF THE UNIFIED DEVELOPMENT CODE. ADDITIONALLY, I UNDERSTAND THAT CITY COUNCIL APPROVAL OF A SITE PLAN IN CONJUNCTION WITH ZONING CASE DOES NOT RELIEVE ME FROM ADHERENCE TO ANY/ALL CITY-ADOPTED CODES AT THE TIME OF PLAN SUBMITTAL FOR BUILDING PERMITS.

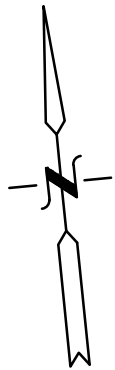

BAIN MEDINA BAIN, INC.
ENGINEERS & SURVEYORS
7073 San Pedro Avenue
San Antonio, Texas 78216
P: (210)494-7223, F: (210)490-5120
TBPE No. F-1712/TBPLS No. 10020900

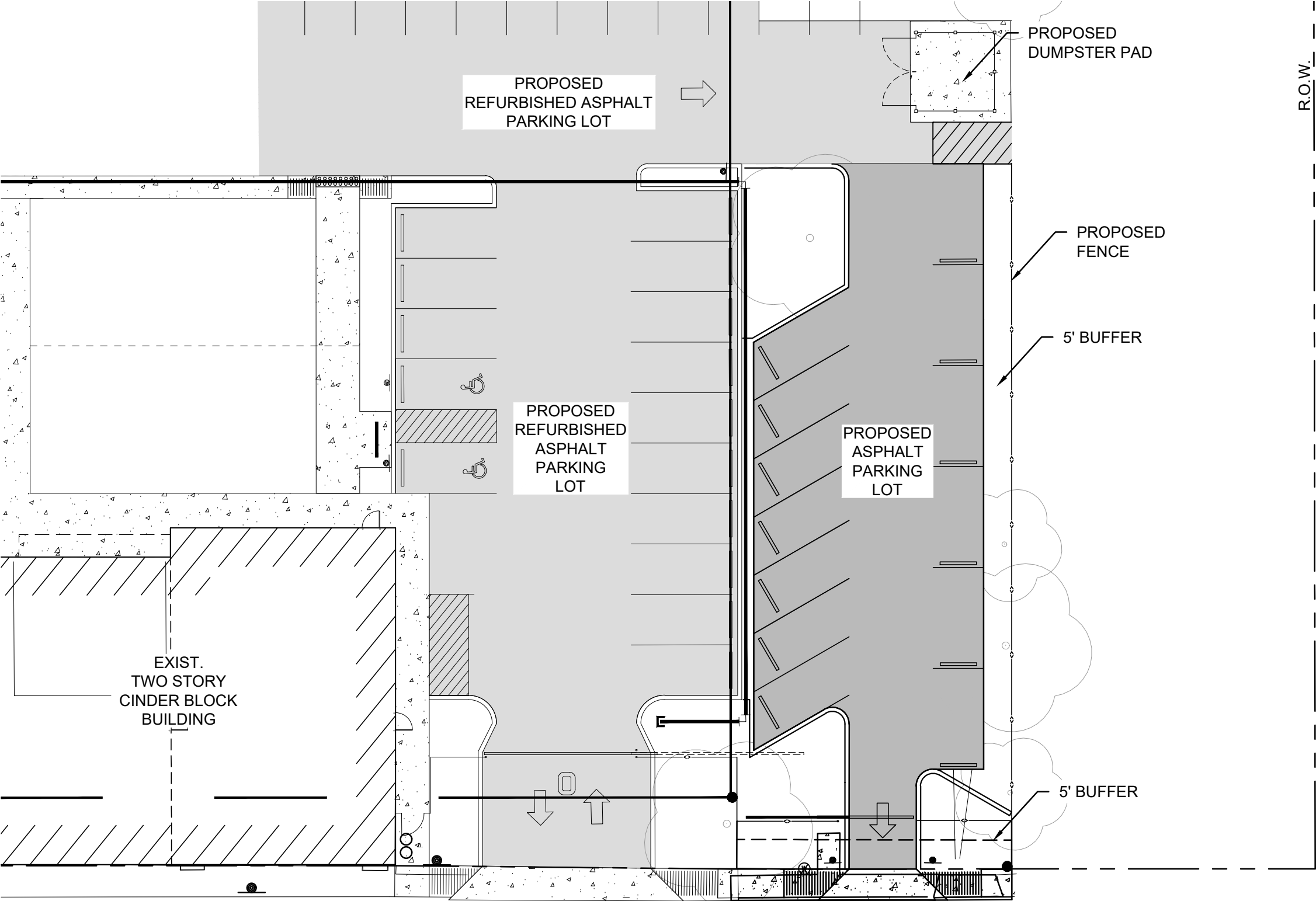

N. ROSILLO STREET

W. MARTIN STREET

ADDITIONAL PARKING OPTION

SCALE: 1" = 20'

Z-2024-10700161 (COUNCIL DISTRICT 5):
FROM: "R-6" RESIDENTIAL SINGLE-FAMILY DISTRICT
TO: "IDZ-1" LIMITED INTENSITY INFILL DEVELOPMENT ZONE WITH
USES PERMITTED FOR NONCOMMERCIAL PARKING LOT

PRELIMINARY

FOR REVIEW ONLY
Not for construction,
bidding or permit purposes.



BAIN MEDINA BAIN, INC.

Engineer:

LORENA CARTER
P.E. No. 116832

10/30/24
Date

DATE: 10/30/24
DWG. BY: JML

Date: Nov 01, 2024, 4:19pm User ID: mlinton
File: W:\Work\C-1609 Basilio Flocks Project - DreamOn\Design\Civil\C-1609 Additional Parking\Exhibits\ADDITIONAL PARKING OPTION.dwg