

Data Source: City of San Antonio Enterprise GIS, Bexar Metro 911, Bexar Appraisal District
 "This Geographic Information System Product, received from The City of San Antonio is provided 'as is' without warranty of any kind, and the City of San Antonio accepts no responsibility for errors and omissions, including but not limited to the implied warranties of merchantability and fitness for a particular purpose. The City of San Antonio does not warrant, guarantee, or make any representation as to the accuracy or the results of the use of the information provided to you by the City of San Antonio in terms of correctness, accuracy, reliability, timeliness or otherwise. The user shall be responsible for the results and performance of any information obtained from the City of San Antonio is solely accepted by the recipient." Please contact the responsible City of San Antonio Department for specific determinations.
 City of San Antonio Planning Department GIS Manager: Wendy Woodruff, wendy.woodruff@sanantonio.gov. Maps may be ordered at: (210) 207-7873
 Map Created by: Gustavo Gutierrez
 Map Creation Date: 4/10/2024
 Map File Location: \\scomms\misc\29\GIS\Plan50\plan_10\Archived\Neighborhoods
 Land_Use\Amendments\Amend_2411600018_NSec_B&W.mxd
 PDF Filename: Amend_2411600032_NSec_B&W.pdf



200' Notification Area
 Proposed Land Use Change



Specialized Center
 Regional Center
 Suburban Tier

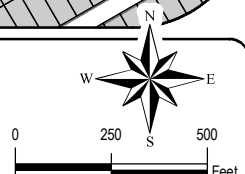

North Sector Land Use Plan **Proposed Plan Amendment 2411600032 Area**

City of San Antonio
 Development Services
 Department
 Michael Shannon, PE, CBO
 City of San Antonio Development and
 Business Services Center
 PO Box 639641
 San Antonio, TX 78263

