

Property Location: Generally Located at Petroleum Common Road, east of I-37 S

Legal Description: CB 4010L BLK 2 LOT 7

Current Zoning: I-2

Proposed Zoning: I-2 S with Specific Use Authorization for Bulk Plant/Terminal (Includes Bulk Storage of Petro Chemicals)

--Total Buildable Ground Square Footage: 218,061 SF

--Warehouse/Office Footprint: 30,000 SF

--Parking and Fencing as shown.

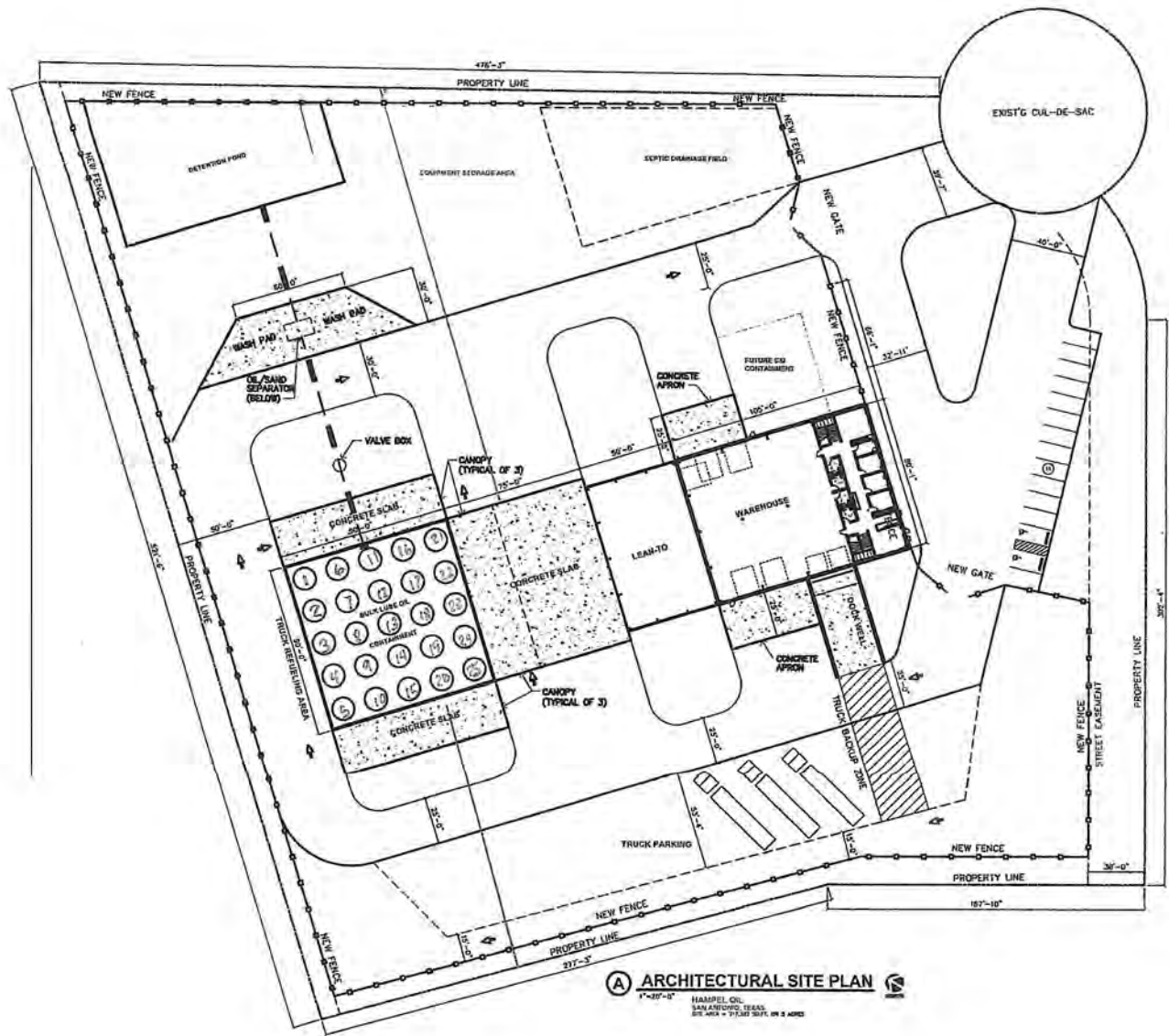

I, Hampel Leasing, Inc., the property owner, acknowledge that this site plan submitted for the purpose of rezoning this property is in accordance with all applicable provisions of the Unified Development Code. Additionally, I understand that City Council approval of a site plan in conjunction with a rezoning case does not relieve me from adherence to any/all City-adopted Codes at the time of plan submittal for building permits.