

Z-2023-10700239
From: "C-3NA S" General Commercial Nonalcoholic Sales District with a Specific Use Authorization for Warehousing and Open Storage
To: "IDZ-2"Medium Intensity Infill Development Zone with uses permitted for thirty-three (33) dwelling units
Address: 1010 West Ashby Place
Legal: Lots 29-37, Block 2, NCB 3597

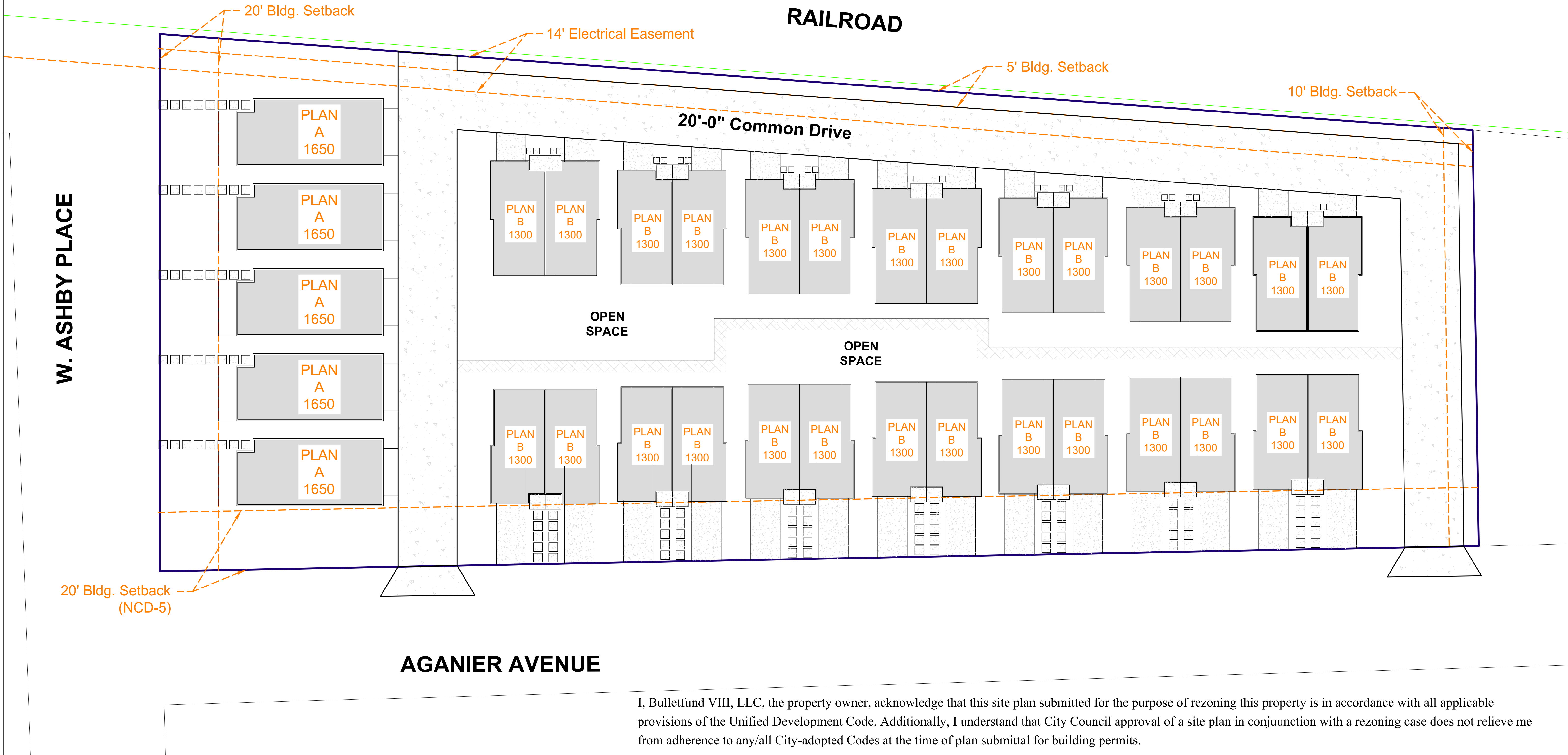

Lot Information	
Lot Area:	1.54 ac
Unit/AC:	21.42
Total Lots:	1
Total Units:	33

Unit Square Footage		
PLAN A:	5	1,650 SF
PLAN B:	28	1,300 SF
Total SF:	44,650 SF	

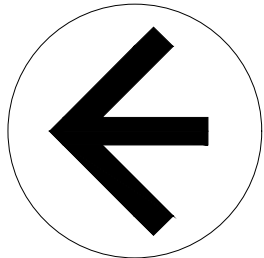

NORTH

1010 W. Ashby Place	Scale	Sheet
Project Name		
Preliminary Site Plan - 33 Units	1" = 1'-0"	S
Sheet Name	Scale	